



# City of Mercer Island Property Hazard Report

Site Address: 5236 W MERCER WAY

Parcel #: 1924059324

Report Generated on March 10, 2026

### Potential Slide:

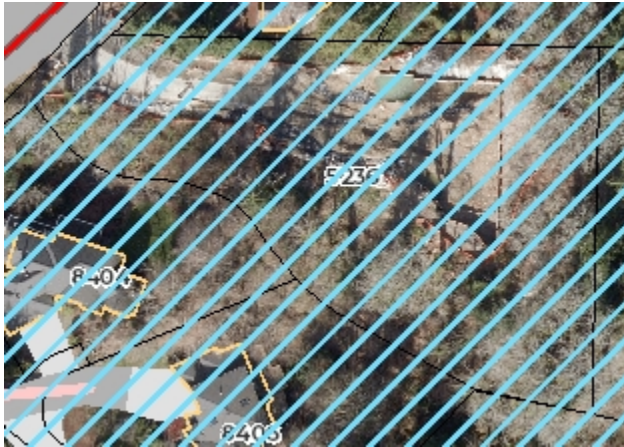

### Steep Slope:



### Erosion:



### Seismic:

**No Hazard Found**

### Wind Exposure:



### Wind Speed Up Values

1.0 1.3 1.6 1.9



These maps are for the use of City of Mercer Island staff for the purposes of permit application evaluation. It provides a general assessment of known or suspect hazard areas for which the City will require site and project specific evaluation by a Washington State licensed engineer, geologist or engineering geologist prior to issuing a site for development. All areas have not specifically evaluated for hazards and there may be locations that are not correctly represented on these maps. It is the responsibility of the property owners and map users to evaluate risk associated with their proposed development. No site-specific assessment of risk is implied or otherwise indicated by the City of Mercer Island by these maps.